

R C A Series

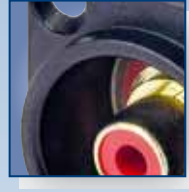

Profi® RCA Series

Phono Socket



NF2C-B-2



NF2D-4



NF2D-B-6

- Makes ground before signal contact and breaks signal before ground
- No more disturbing noise and broken speaker cones
- Precisely machined to our demanding quality standards
- Neutrik® unique chuck type strain relief
- Gold plated contacts

- Makes ground before signal contact and breaks signal before ground
- No more disturbing noise and broken speaker cones
- Precisely machined to our demanding quality standards
- Gold plated contacts

NF2C

NF2D-*

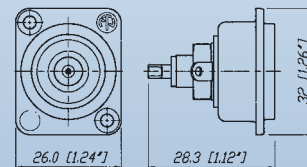
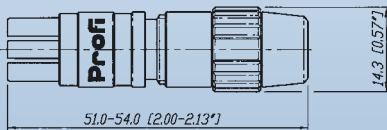

* available in 9 colours see page 58

RCA Series

Specification		Profi®	Phono Socket
Electrical			
Rated current per contact:	16 A rms continuous	•	•
Rated insulation voltage:	50 V ac	•	•
Contact resistance:		> 100 GΩ	< 5 GΩ
Dielectric strength:		1500 V dc	500 V dc
Capacitance (pin to shell):		7 pf	9 pf
Mechanical			
Life time (mating cycles):	> 5000	•	•
Cable O.D. range:	3.0 - 7.3 mm	•	-
Wiring:	soldering	•	•
Max. wire size :	2.5 mm ² / 14 AWG	•	-
Cable anchoring:	Neutrik® chuck type strain relief	•	-
Solderability:	complies with IEC 68-2-20	•	•
Material			
Housing:	Brass (CuZn39Pb3)	•	-
	Zinc diecast (ZnAlCu1)	-	•
Insert:	PBTP 20% GR	•	-
Contacts:	Brass (CuZn39Pb3)	•	•
Contact plating:	5 μm Au plated over 5 μm Ni	•	•
Chuck:	Polyacetal (POM)	•	-
Environment			
Temperature range:	-30°C to +80°C	•	•
Protection class:	IP 40	•	•
Flammability:	UL 94 HB	•	•

Ordering Information

Phono Profi®

NF2C-B2 Professional "phono Plug" (RCA or CINCH type), two plugs with red and black coding, two strain relief chucks for a second cable diameter

Phono (RCA) Socket

NF2D-* Chassis Phono (RCA) socket in D Shape housing

NF2D-B-* Chassis Phono (RCA) socket in black D Shape housing

* color coding: 0 - Black, 1 - Brown, 2 - Red, 3 - Orange, 4 - Yellow, 5 - Green, 6 - Blue, 7 - Violet, 8 - Grey, 9 - White

Assessories

SCL Plastic sealing cover to protect the connector sockets against dust and moisture

SCDX Hinged cover seals D-size chassis connectors, IP54 rated